

INTAKE VALVE

RH30 - RH38 - RH60



APPLICATION: Installed at the compressor inlet to control compressor capacity. At the start-up the valve stays open till a control signal is applied to close the valve and restrict the flow. During normal operation the valve open and close in response to a control signal to meet the air demand. At the shut-down a check valve stays closed to prevent back flow through the compressor. The valve can be ordered in the non-return working system.

INSTALLATION: At the suction flange of the air-end, either directly or by flange adaptor, depending on the type of air-end. The ON/OFF system must be connect to the signal pressure and solenoid valve.

REPLACEMENT: The stress on valve parts depends on compressor application and operating parameters. Inspect the valve and replace, using VMC spare part kit, after 8.000 operating hours.

TECHNICAL DATA

Size	RH30		RH38		RH60	
Rate Flow fully open m ³ /1'	See the diagram					
Working System	Non-return or On/Off				Non-return, On/Off and Proportional	
Solenoid-valve voltage	24V, 110V or 230V					
Materials	Housing in Aluminium alloy. Internal parts in Aluminium alloy, Steel, Brass, Viton sealings and PTFE					
Adjustment	Adjustable control device to unload vessel through inlet manifold during idling					
	Circular base		Rectangular base			
X mm	90		115		125	
Y mm	Ø84		80x73		100	
*Z_V mm	132		155		132	
K	64		80,5		124,5	
W mm (")	Rp 1"	Ø20	Ø20	Rp 1"	Ø20	Ø20
V mm (")	Ø40	Ø30	Rp 3/4"	Ø40	Ø30	Rp 3/4"
I1 mm	Ø73		□ 62x55		Ø100	
I2 mm	-		-		Ø115	
I3 mm	Ø7,2		Ø8,5		Ø9	
I4 mm	-		-		Ø10,2	
O1 mm	Ø59,5		-		Ø70	
O2 mm	Ø63,5		-		Ø76	
O3 mm	-		-		Ø82	
O4 mm	-		-		Ø88	
Weight kg	0,6		0,8		1,5	

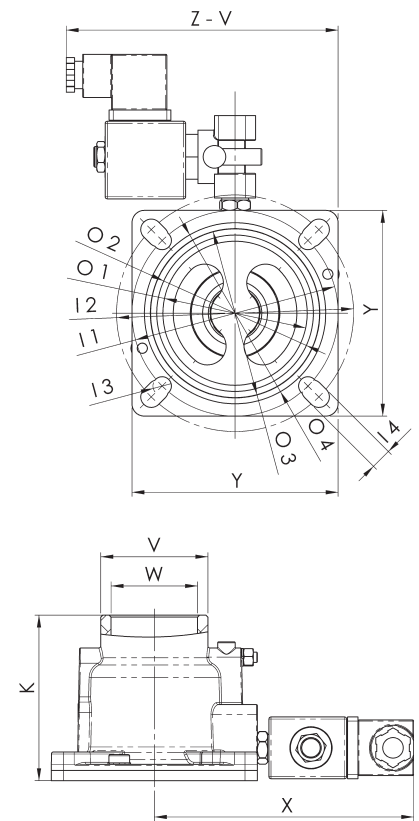

ATTENTION: The drawing above is not appropriated to all models. Look at in our website all specific draws.

PRESSURE DROP DIAGRAM:

